

Brought to you by [sewingideas.com](http://sewingideas.com)

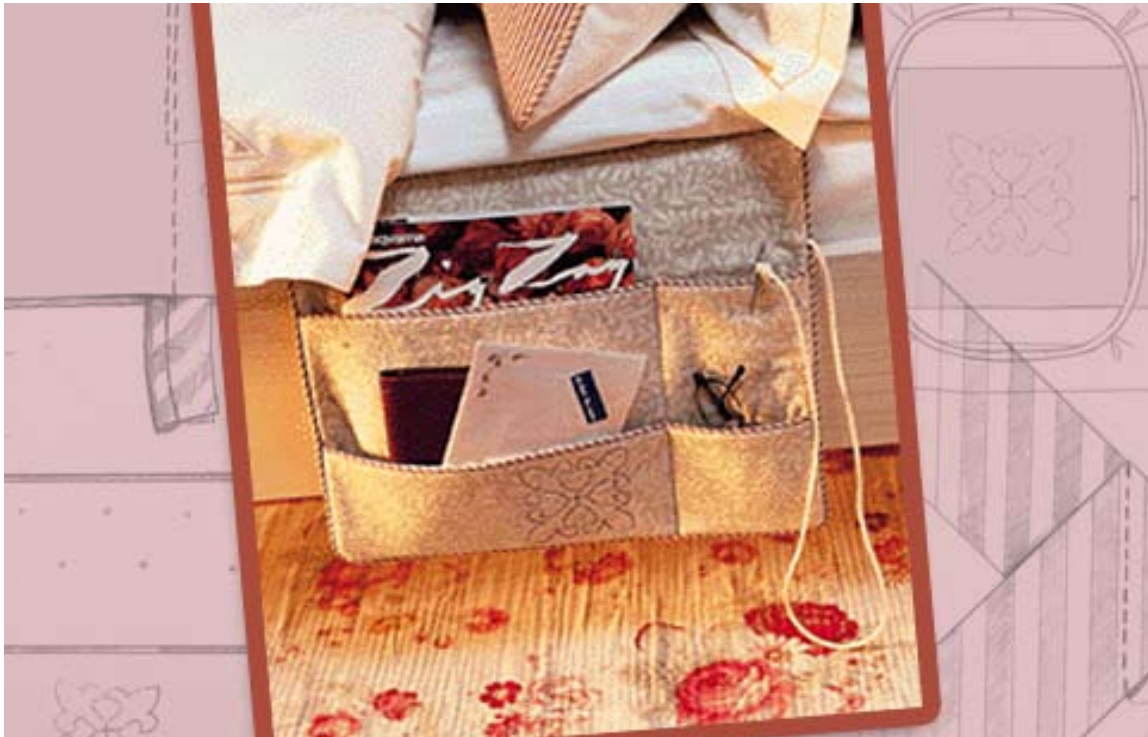

## Bedside Caddy



### Shopping List:

- Small print for front pieces 1/2 yard (45 cm)
- Stripe or second print for back pieces 1/2 yard (45 cm)
- Batting 1/2 yard (45 cm)
- Small stripe for piping 5/8 yard (60 cm)
- Cable cord to cover for piping and to attach pen/pencil 4 yards (3.65 cm)
- Pen or pencil in a color to match the fabric
- Husqvarna Viking Piping Foot # 411 85 10-45
- Husqvarna Viking Dual Feed Foot

# Bedside Caddy

## Shopping List:

- Small print for front pieces 1/2 yard (45 cm)
- Stripe or second print for back pieces 1/2 yard (45 cm)
- Batting 1/2 yard (45 cm)
- Small stripe for piping 5/8 yard (60 cm)
- Cable cord to cover for piping and to attach pen/pencil 4 yards (3.65 cm)
- Pen or pencil in a color to match the fabric
- Husqvarna Viking Piping Foot # 411 85 10-45
- Husqvarna Viking Dual Feed Foot

 Husqvarna **VIKING**

## Cut

One piece of each of the following measurements from two different fabrics • One for front and one for back. Cut one of each from batting • 16" x 28" (41 cm x 71 cm) for front, back, batting • 16" x 10" (41 cm x 25 cm) for top pocket front, back, batting • 16" x 5" (41 cm x 13 cm) for bottom pocket front, back, batting

Note: Measurements include 1/2" (12 mm) seam allowance on all pieces.

## Instructions:

1

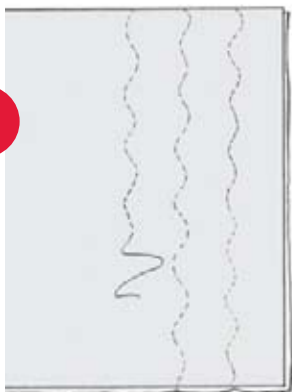

Quilt the front pieces to batting: Place batting pieces against the wrong side of front, and both pockets. Pin, baste, or spray with temporary fabric adhesive to hold the layers together. To channel quilt the large front piece, put on the Dual Feed foot and slide in the right edge/quilting guide and position it 2 inches (5 cm) from the needle. Touch straight stitch or one of the special serpentine quilting stitches. Place the edge/quilting guide along the edge of the fabric and sew the first row. Place the guide along the first row of stitching and stitch the next row. Continue in the same manner across the front piece. Illustration 1.

2

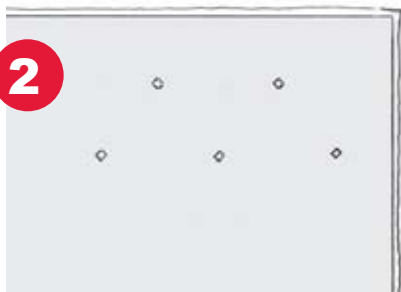

To single stitch tie quilt the larger top pocket piece, touch a favorite decorative stitch and STOP. We chose stitch . Use the Pictogram pen to mark dots every 2" (5 cm) across the pocket, 1" (2.5 cm) from top edge. Mark alternate rows below the first. Stitch the single stitch on marks. Illustration 2.

3

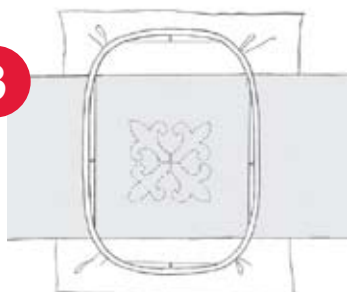

To embroidery quilt the smallest pocket, straight stitch pocket (or use spray adhesive) to a piece of Husqvarna Tear-A-Way stabilizer that is larger than the hoop. Select a favorite embroidery. This is the hard part with so many to choose from. The Husqvarna Viking Embroidery Booklets picture the embroidery full size. Trace the embroidery onto the placement template, position template on pocket/stabilizer, and mark the center and top/bottom/side placement lines. Hoop the stabilizer and pocket matching placement lines to the corresponding hoop marks. Stitch embroidery. Illustration 3.

4

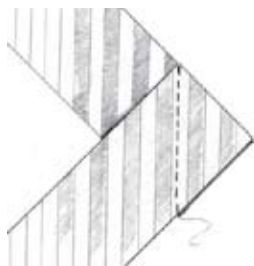

For decorator diagonal stripe piping, cut bias strips 1 1/2" (4 cm) wide from a striped fabric. Cutting the stripe on the bias gives the diagonal stripe on the piping. You will need about 130 inches (3.3 m) of bias strip. To piece strips together, place them right sides together on a 90 degree angle and sew on a diagonal. Illustration 4.

Touch straight stitch and snap on the Piping foot. Place the cable cord on the wrong side of the bias strip, wrap the fabric around the cord and place under the piping foot with the cord riding in the groove of the presser foot. Stitch. Continue to use piping foot to stitch piping along top edge of both pockets and all the way around the back piece.

5

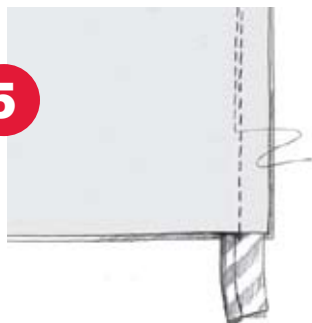

### LINE POCKETS

Place the pocket back pieces right sides together with the fronts and stitch along the piped edge only with the piping foot. Adjust needle position slightly closer to the piping to completely cover the original rows of stitching. Turn the pockets to the right side and press. Illustration 5.

6



Pin the larger pocket onto the front piece with the wrong side of the pocket to the right side of the front, matching bottom edges. Place the smaller pocket on top of the larger with the right side up, matching bottom edges. Illustration 6.

Stitch pockets to front piece along the sides and bottom edges using the piping foot. Tie a pen or pencil to a length of cable cord and pin cord end along one side edge at the top of the large pocket. Tuck the pencil and excess cord into the pocket to keep it out of the way for final stitching. Place back piece on top of front and pockets, right sides together. Stitch around the outside leaving an opening along the bottom edge for turning. Turn right side out through the opening and press well. Topstitch to close the opening. Place a book, magazine, etc. in the pockets and mark size for stitching to divide pockets into smaller sizes. Stitch vertically over markings with a decorative stitch. Place the top half of the bedside caddy under the mattress, fill the pockets and enjoy!